

OWNER
 RICHARDSON INDEPENDENT SCHOOL DISTRICT
 400 S. GREENVILLE AVE.
 RICHARDSON, TX 75081

ARCHITECT
 HKS, INC.
 350 N. SAINT PAUL ST., SUITE 100
 DALLAS, TX 75201-4240

STRUCTURAL ENGINEER
 HKS, INC.
 350 N. SAINT PAUL ST., SUITE 100
 DALLAS, TX 75201-4240

MEP ENGINEER
 REED, WELLS, BENSON CONSULTING ENGINEERS
 12001 N. CENTRAL EXPRESSWAY, SUITE 1100
 DALLAS, TX 75243

CIVIL ENGINEER
 RLK CONSULTING ENGINEERS
 12001 N. CENTRAL EXPRESSWAY, SUITE 300
 DALLAS, TX 75243

LANDSCAPE ARCHITECT
 CCA LANDSCAPE ARCHITECT
 12700 HILLCREST RD., SUITE 149
 DALLAS, TX 75230

LAKE HIGHLANDS HIGH SCHOOL ADDITION AND RENOVATION



REVISION NO. DESCRIPTION DATE

HKS PROJECT NUMBER

XXXXX

DATE

09 AUGUST, 2018

ISSUE

PD 467 - CITY OF DALLAS

SHEET TITLE
PD LANDSCAPE PLAN

SHEET NO.
L100

M189-037

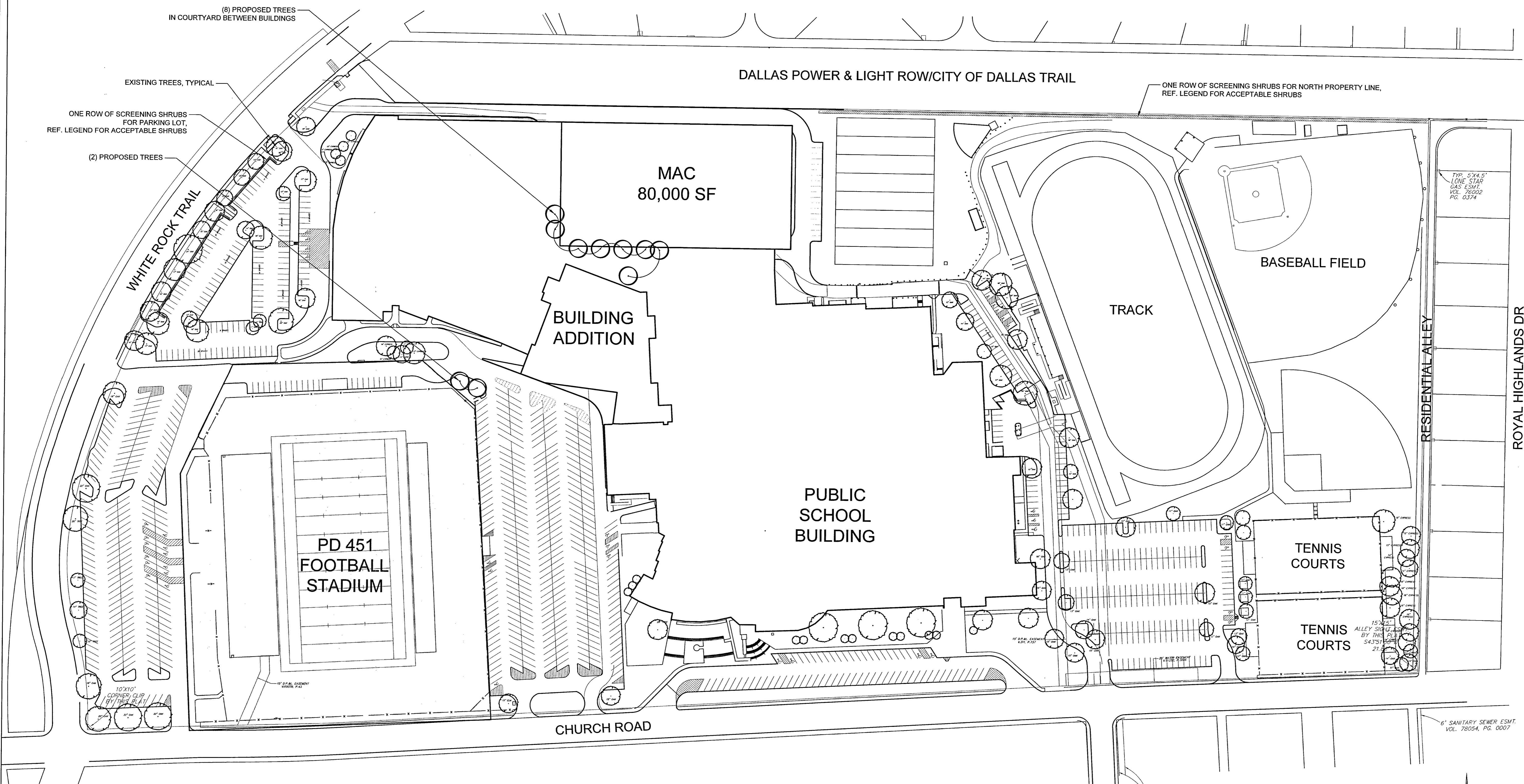

1 LAKE HIGHLANDS HIGH SCHOOL - LANDSCAPE PD PLAN
 1" = 80'-0"

LEGEND

- EXISTING SHADE / CANOPY TREE:**
 - TREE CALIPER SIZE AS OF 2018, IF TO BE REPLACED, REPLACE WITH 3" CALIPER TREE FROM LIST BELOW
 - TEXAS ASH / *FRAXIMUS TEXENSIS*
 - CEDAR ELM / *ULMUS CRASSIFOLIA*
 - LACEBARK ELM / *ULMUS PARVIFOLIA*
 - LIVE OAK / *QUERCUS VIRGINIANA*
 - BUR OAK / *QUERCUS MACROCARPA*
 - CHINOQUAPIN OAK / *QUERCUS MUEHLBERGII*
 - SHUMARD OAK / *QUERCUS SHUMARDII*
 - PECAN / *CARYA ILLINOINENSIS*
 - CHINESE PISTACHE / *PISTACIA CHINENSIS*
 - BALD CYPRESS / *TAXODIUM DISTICHUM*
- PROPOSED SHADE / CANOPY TREE FOR NEW ADDITION (3" CALIPER MIN.):**
 - TEXAS ASH / *FRAXIMUS TEXENSIS*
 - CEDAR ELM / *ULMUS CRASSIFOLIA*
 - LACEBARK ELM / *ULMUS PARVIFOLIA*
 - LIVE OAK / *QUERCUS VIRGINIANA*
 - BUR OAK / *QUERCUS MACROCARPA*
 - CHINOQUAPIN OAK / *QUERCUS MUEHLBERGII*
 - SHUMARD OAK / *QUERCUS SHUMARDII*
 - PECAN / *CARYA ILLINOINENSIS*
 - CHINESE PISTACHE / *PISTACIA CHINENSIS*
 - BALD CYPRESS / *TAXODIUM DISTICHUM*
- EXISTING OR PROPOSED ORNAMENTAL TREE (2" CALIPER MIN.):**
 - DECIDUOUS HOLLY / *ILEX DECIDUA*
 - DESERT WILLOW / *CHILOPSIS LINEARIS*
 - RED BUD / *CERIS CANADENSIS* OR *REINIFORMIS*
 - CRAPE MYRTLE / *LAGERSTROEMIA INDICA*
 - EVE'S NECKLACE / *SOPHORA AFFINIS*
 - YAUPOH HOLLY / *ILEX VOMITORIA*
 - FRINGE TREE / *CHIONANTHUS VIRGINICUS*
 - BOTTLEBRUSH / *CALLISTEMON RIGIDUS*
 - CRABAPPLE / *MALUS 'PRAIRIFIRE'*
 - PHUS LANCEOLATE
 - JERUSALEM THORN / *PARKINSONIA ACULEATA*
 - AMERICAN HORNBEAM / *CARPINUS CAROLINIANA*
 - BLACKHAW VIBURNUM / *VIBURNUM RUFIDULUM*
- SCREENING SHRUBS FOR PARKING LOT - EVERGREEN OR SEMI-EVERGREEN (6 GAL. MIN.):**
 - DWARF BURFORD HOLLY / *ILEX CONUTA 'BURFORDI NANA'*
 - INDIAN HAWTHORN / *RAPIHOLEPIS INDICA*
 - NEEDLEPOINT HOLLY / *ILEX CORNUTA*
 - TEXAS SAGE / *LEUCOPHYLLUM FRUTESCENS*
- SCREENING SHRUBS FOR NORTH PROPERTY LINE - EVERGREEN (6 GAL. MIN.):**
 - PHOTINIA / *PHOTINIA X FRASERI*
 - NELLIE R. STEVENS HOLLY / *ILEX X 'NELLIE R. STEVENS'*
 - ELAEAGNUS / *ELAEAGNUS MACROPHYLLA*
 - BARBERRY / *BERBERIS THUNBERGII*

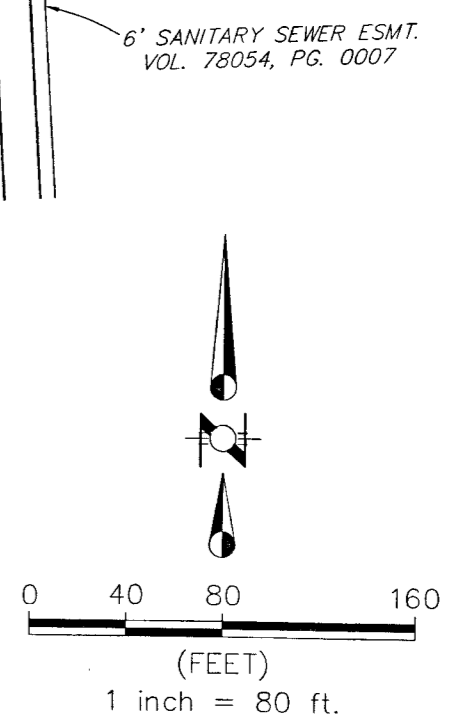
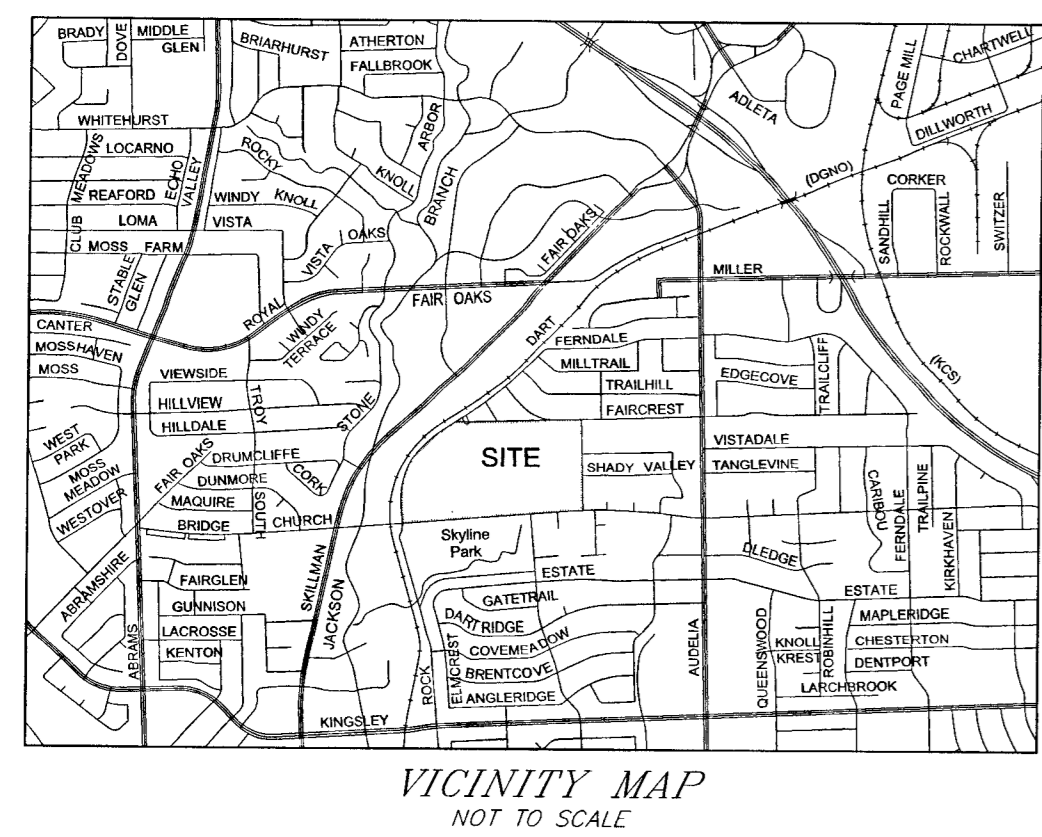

INTERIM REVIEW ONLY
 These documents are incomplete, and are released for interim review only and are not intended for regulatory approval, bidding, permit, or construction purposes.
 Landscape Architect: *Anna App. Cal.*
 Arch. Reg. No.: Texas 1275
 Date: 01-24-2019

PLOT DATE: 7/27/2018 12:05:51 PM TEMPLATE VERSION: TEMPLATES_Ver01.dwg